



DLM Forum Members' Meeting

Gdańsk, 4 –5 June 2025



PRACTICAL INFORMATION

The State Archives of Poland are pleased to host the DLM Forum Members' Meeting in Gdańsk. Gdańsk is a city on the Baltic coast of northern Poland. It is Poland's principal seaport and the country's fourth-largest metropolitan area. Gdańsk is a city with a unique history, which has had a significant impact on its contemporary landscape. For centuries, it has been a melting pot where diverse cultures, peoples, and traditions have formed a unique community.



Venue:

Kunst Wodny Building
The City Culture Institute

Targ Rakowy 11
80-806 Gdańsk



Photo by The City Culture Institute

Social programme:

- **Visit to the State Archives in Gdańsk** (in two groups with the possibility of choosing a convenient date: morning of 4 June or afternoon of 5 June)
- **Tour of the Gdańsk city centre** (in two groups with the possibility of choosing a convenient date: the afternoon of 4 or 5 June)
- **Tour of the European Solidarity Centre** (the afternoon of 5 June)

Travel to Gdańsk:

Getting to Gdańsk should not cause problems. You can reach your destination by various means of transport: by plane, train, ferry, bus, or car.

➤ By train

For those who like to travel by train, we recommend the international connection Berlin — Gdańsk. Trains between the two cities run once a day, seven days a week. You can reach Gdańsk also by trains with a stop at the stations in Poznań or Szczecin. There is also a regular, direct rail connection between Gdańsk and Vienna.

Nearest train station – Gdańsk Główny station, only 9 min. walk from the City Culture Institute.

<https://maps.app.goo.gl/m2JQXFzpZtCFXhMG6>

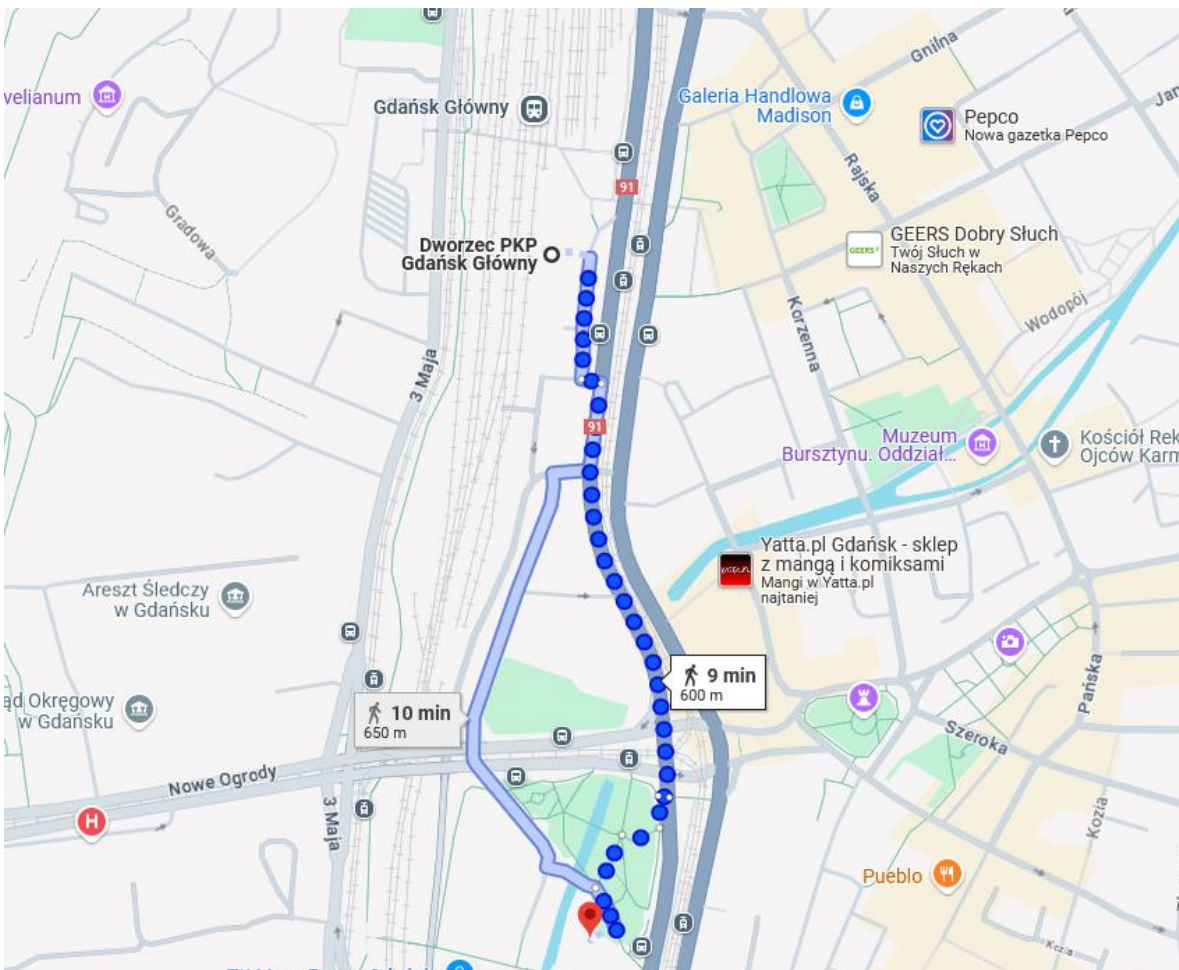

➤ By plane

Nearest airport – Gdansk Lech Walesa Airport

Gdańsk Lech Wałęsa Airport has an extensive network of connections with airports in many European cities, served by airlines such as Lufthansa, SAS, Wizzair, Ryanair, Eurowings, airBaltic and Finnair. Connection map: <https://www.airport.gdansk.pl/flight-information/where-we-fly-p3.html>

From the Airport, there are several public transport options to the city centre.

The easiest way to get to *Gdańsk Główny* (the main train station) from the Airport is taking a PKM train (Pomeranian Metropolitan Railway, POLREGIO). The PKM connects to the SKM train (Fast Urban Railway), which assists in regional travel and getting from the Airport. You can change trains from PKM to SKM and vice versa at *Gdańsk Główny* and *Gdańsk Wrzeszcz* station.

The train station (*Gdańsk Port Lotniczy* station) is located directly in front of the passenger terminal.

There are ticket machines on the platforms. Payment for tickets is possible in cash and with credit cards. You can also purchase tickets from the train manager.

SKM trains depart from platform 1 and 2 at *Gdańsk Wrzeszcz* station for the center of Gdańsk. On that note, the journey from the Airport to *Gdańsk Główny* (via *Gdańsk Wrzeszcz*) takes around 45 min.

You can purchase SKM tickets via apps such as jakdojade.pl or in ticket machine located at the stations, or train manager (in the first wagon).

There is also a direct bus connection to the *Gdańsk Główny* with bus 210 from the Airport (runs twice an hour) or you can also take a taxi (we recommend Neptun Taxi).

More information:

<https://www.airport.gdansk.pl/passenger-area/transportation/train-p98.html>

Alternative flight options:

You can also land at the airport in Warsaw: **Warsaw Chopin Airport** (in the city) or **Warsaw Modlin Airport** (is an airport located in the town of Nowy Dwór Mazowiecki, approx. 40 km (25 miles) north of central Warsaw) and then take a direct train to Gdańsk from [Warsaw Central station](#) (*Warszawa Centralna* Train Station).

- ✓ From Warsaw Chopin Airport, you can travel **by bus 175**: you should get on at the bus stop: *Lotnisko Chopina - Przyłoty 02* (towards Pl. Piłsudskiego) and get off at the bus stop: *Dworzec Centralny 01* or **by train SKM**: you should get on at the train station: *Warszawa Lotnisko Chopina* (towards Sulejówek Miłosna) and get off at the train station: *Warszawa Śródmieście*;

- ✓ From Warsaw Modlin Airport, you should get on at the bus ZL Modlin at the bus stop: *Lotnisko Modlin* and get off at the bus stop: *Modlin*. Then you should get on the train at the train station: *RL93124/5Warszawa Lotnisko Chopina* and get off at the train station: *Warszawa Centralna*.

➤ **By bus**

Line buses are another popular means of transport in Poland. The line supporting the most connections is the FLIXBUS line. Contact: <https://www.flixbus.pl/>.

In addition to the line mentioned above, there are other, smaller companies. Comprehensive information on all bus and train connections you can find at: <https://www.e-podroznik.pl/>.

➤ **By car**

If you are travelling by car, we recommend choosing expressways and highways.

➤ **By ferry**

If you travel from **Sweden** – you can reach the port of Gdańsk six days a week, and daily in summer, from the Swedish Nynäshamm by picking the ferry POLFERIES. Detailed information is available at: <https://polferries.com/>.

You can also choose a ferry route from Karlskrona, served by the STENA LINE. However, this ferry sails to the port of Gdynia, a city located in the immediate vicinity of Gdańsk, from where you can easily reach Gdańsk by public buses and a city train.

Public transport in Gdańsk:

Tickets for buses and trams are the same. You can obtain them from ticket booths (rare) or vending machines. Payment for tickets is possible in cash and with credit cards.

After entering the bus/tram, you need to validate the ticket. You only need to do it once. It is also possible to buy tickets using apps ([Jakdojade](#), [moBiLET](#)) but we recommend doing it before entering the vehicle. If you buy them via apps, you do not need to validate them, and they will appear in the app.

[Jakdojade](#) application allows you to check schedules, real-time departures, routes, maps, and buy tickets. It also works for transport in other cities.

There are **one-ride tickets**, that are only valid for one ride – after you leave the bus/tram you must buy another one to go further.

There are also **time tickets**, that allow you to change buses and trams until the ticket runs out of time (75 minutes, 24h and 72h).

List of hotels in the centre of Gdańsk:



Hotels 5 *****		
Name of the hotel	Address	Distance from the venue
Hilton Gdansk *	Targ Rybny 1, 80-838 Gdańsk +48 58 778 71 00 https://www.hilton.com/en/hotels/gdnhghi-hilton-gdansk/	1 km (15-min walk)
Chleb i Wino Gdansk Apartments	ul. Stągiewna 17, 80-750 Gdańsk +48 535 300 535 http://apartamentycholebiwino.eu/	1.1 km (15-min walk)
Radisson Blu * \$	ul. Długi Targ 19, Gdańsk +48 58 325 4414 https://www.radissonhotels.com/en-us/hotels/radisson-blu-gdansk?cid=a%3Ase+b%3Agmb+c%3Aemea+i%3Alocal+e%3Ard+b%3Aerut+h%3Aplgdn1 10% discount booking by email: reservations.gdansk@radissonblu.com	950 m (13-min walk)
Hotels 4*****		
Mercure Gdansk Stare Miasto *	ul. Jana Heweliusza 22, 80-890 Gdańsk +48 58 321 00 00 https://all.accor.com/hotel/3390/index.en.shtml	1 km (14-min walk)
Holiday Inn Gdansk City Centre *	ul. Chmielna 1, 80-750 Gdańsk +48 58 733 40 00 https://www.ihg.com/holidayinn/hotels/gb/en/gdansk/gdncc/hoteldetail?cm_mmc=GoogleMaps--HI--PL--GDNCC	1.2 km (16-min walk)
Central Hotel \$	ul. Podwale Grodzkie 4, 80-895 Gdańsk +48 58 351 09 10, +48 539 545 686 https://centralhotelgdansk.pl/en 20% discount	500 m (7-min walk)
Hotel Sadova \$	ul. Łąkowa 60, 80-769 Gdańsk, +48 58 382 30 20 https://www.hotelsadova.pl/en/ 15% discount - rooms at special prices available from June 3rd to 8th	1.6 km (22-min walk)
PURO Gdansk Stare Miasto * \$	Stągiewna 26, 80-750 Gdańsk +48 58 563 50 00, https://purohotel.pl/en/gdansk/ 30% discount - rooms at special prices available from June 3rd to 8th booking by email: gdansk@purohotel.pl	1.1 km (15-min walk)
Qubus Hotel \$	ul. Chmielna 47/52, 80-748 Gdańsk +48 58 752 2 100	1.2 km (16-min walk)

	https://www.qubushotel.com/en/hotel-gdansk/ 10% discount - rooms at special prices available from June 3rd to 6th	
Radisson Hotel & Suites *	ul. Chmielna 10, Gdańsk +48 58 600 28 88 https://www.radissonhotels.com/en-us/hotels/radisson-gdansk?cid=a%3Ase+b%3Agmb+c%3Aemea+i%3Alocal+e%3Arad+d%3Aeerut+h%3APLGDNHST	1.1 km (15-min walk)
Scandic Gdansk *	Podwale Grodzkie 9, 80-895 Gdańsk + 48 58 300 60 00 https://www.scandichotels.com/hotels/poland/gdansk/scandic-gdansk	800 m (11-min walk)
Hotels 3***		
Hampton by Hilton Gdańsk Old Town *	ul. Lektykarska 4, 80-831 Gdańsk +48 58 670 33 33 https://www.hilton.com/en/hotels/gdnhxxh-hampton-gdansk-old-town/	600 m (9-min walk)
Liberum Residence Old Town	ul. Długa 84/85, 80-831 Gdańsk + 48 729 199 099 http://www.liberumgdansk.pl/en	400 m (6-min walk)
Dom Muzyka	Łąkowa 1-2, 80-743 Gdańsk +48 58 326 06 00 http://dommuzyka.pl/en/	1.6 km (22-min walk)
Number One Hotel	ul. Jaglana 4, 80-749 Gdańsk +48 58 717 80 00 https://www.granohotels.pl/numberone	1.3 km (18-min walk)
Hotel Wolne Miasto	ul. Św. Ducha 2, 80-834 Gdańsk +48 58 322 24 42, +48 504 275 536 www.hotelwm.pl/	450 m (6-min walk)
Novotel Gdansk Centrum	ul. Pszenna 1, 80-749 Gdańsk +48 58 300 27 50 https://all.accor.com/hotel/0523/index.en.shtml	1.1 km (15-min walk)
Hotels 2**		
ibis Gdansk Stare Miasto	ul. Heweliusza 4, 80-861 Gdańsk +48 58 300 67 00 https://all.accor.com/hotel/9835/index.en.shtml	1.1 km (15-min walk)
Marina Club Hotel Gdańsk	ul. Szafarnia 10, 80-755 Gdańsk +48 58 733 60 01 https://www.marinaclubhotel.pl/en/	1.4 km (18-min walk)

* recommended hotels

§ rooms at special prices with the code „GdanskeU2025”



Useful information:

Time zone:

GMT+1 (GMT+2 from last Sunday in March to last Saturday in October).

Dialling code:

+48

Important telephone numbers:

General alarm number 112

The police: 997

Fire service: 998

Emergency medical treatment: 999

Currency:

złoty polski – PLN (zł)

1 PLN = €0,23

€1 = 4,27 PLN, approx.

Electric sockets in Poland:

For Poland, there are two associated plug types: C and E. Plug type C is the plug which has two round pins and plug type E is the plug which has two round pins and a hole for the socket's male earthing pin. Both types are suitable for the power load up to 16 A. The standard voltage is 230 V at a frequency of 50 Hz.

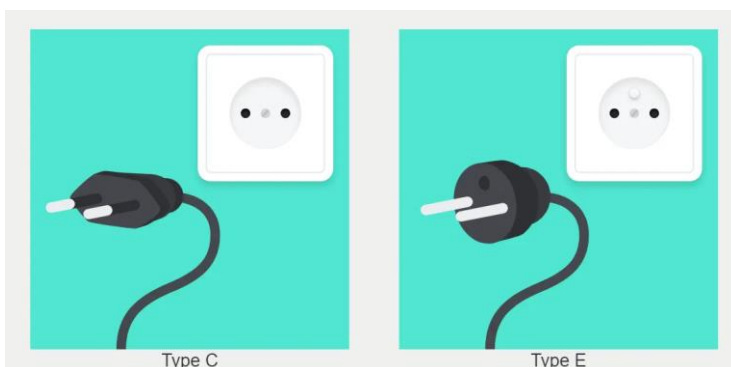

Tourist information:

<https://visitgdansk.com/>

<https://exploregdansk.info/>

<https://www.inyourpocket.com/gdansk/Getting-Around>